

@COBO@
group

miniELLIPSE



@COBO@



SPECIFICHE TECNICHE

- Corpo: poliammide
- Lente: vetro temprato
- Riflettore: tecnologia free-form
- Grado di protezione: IP66
- Lampada: H3
- Connessione: tipo S/SEAL 2 vie

TECHNICAL SPECIFICATIONS

- Housing: polyamide
- Lens: tempered glass
- Reflector: free-form technology
- Sealing: IP66
- Bulb: H3
- Connection: S/SEAL type 2 pins

OPTIONAL KIT DI CONNESSIONE CONNECTION OPTIONAL KIT



30.46.06835
KIT DI CONNESSIONE
S/SEAL 2 VIE
CONNECTION KIT
2 PINS S/SEAL

light pattern SPOT

05.1494.0000

RH

05.1495.0000

LH

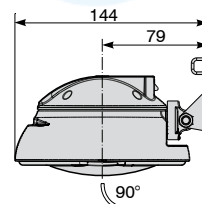
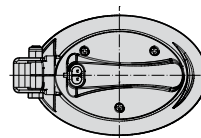
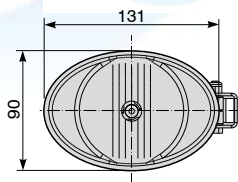

LONG NARROW

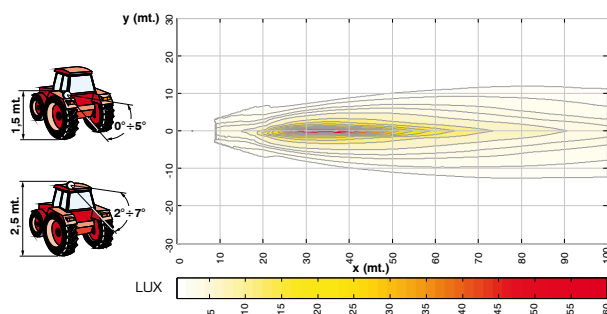

light pattern FLOOD

05.1404.0000

RH

05.1405.0000

LH

05.1404.0500

senza staffa, dado e vite
without bracket, nut and screw

RH

05.1405.0500

senza staffa, dado e vite
without bracket, nut and screw

LH

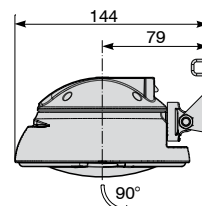
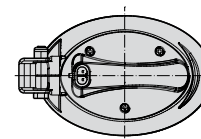
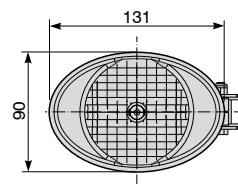

MEDIUM WIDE

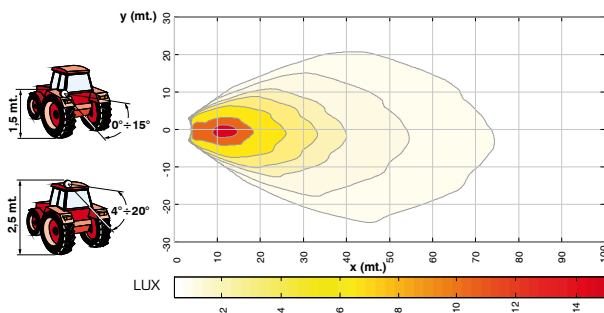

SHORT WIDE

